

MUNICIPALITY OF BUFFALO

PREPARED BY THE
MINNESOTA DEPARTMENT OF TRANSPORTATION
OFFICE OF TRANSPORTATION SYSTEM MANAGEMENT
IN COOPERATION WITH
U.S. DEPARTMENT OF TRANSPORTATION
FEDERAL HIGHWAY ADMINISTRATION

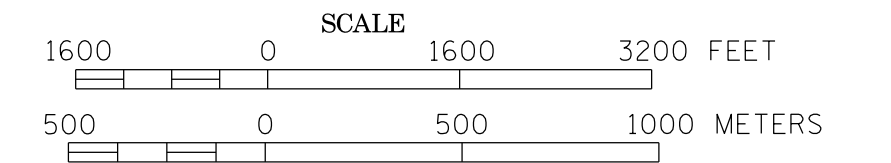

2015
BASIC DATA - 2013

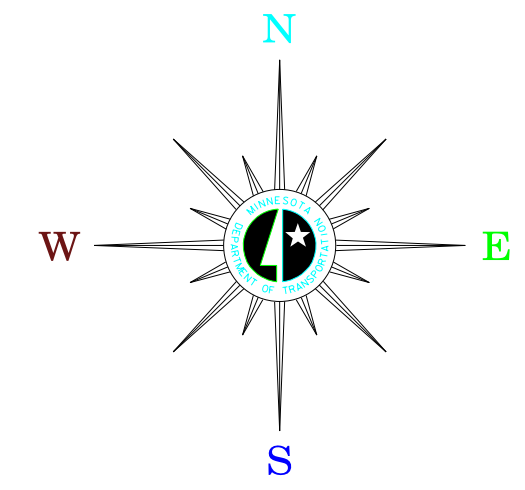

LEGEND

- INTERSTATE TRUNK HIGHWAY..... (15)
- U.S. TRUNK HIGHWAY..... (10)
- STATE TRUNK HIGHWAY..... (55)
- COUNTY STATE AID HIGHWAY..... (25)
- COUNTY ROAD..... (15)
- CORPORATE LIMITS.....
- PUBLIC ROAD.....
- PRIVATE ROAD.....

1. E. FIR ST.
2. E. ELM ST.
3. E. DOUGLAS ST.
4. E. CEDAR ST.
5. E. BIRCH ST.
6. E. ASH ST.
7. MANOR AVE.
8. WALNUT ST.
9. POPLAR ST.
10. ASPEN AVE.
11. SOO LN.
12. HIGHLAND LN.
13. KAREN CIR.
14. KRISTEN CIR.
15. ANNE CIR.
16. WILLOW CREEK CT.
17. GRANDVIEW AVE. N.W.
18. WILLOW CIR.
19. 7TH AVE. N.E.
20. LAKEVIEW PRVT.
21. LAKESIDE CIR.
22. HAWTHORN AVE.
23. JUNIPER LN.
24. SUMMIT DR.
25. KESTREL CT.
26. KESTREL CIR.
27. IBES WAY
28. GOLDFINCH LN.
29. GOLDFINCH PL.
30. EAGLE PL.
31. FALCON LN.
32. CEDAR CREST LN.
33. EAGLE CT.
34. KINGFISHER LN.
35. ROBIN LN.
36. HONEY SUCKLE CIR.
37. SERENITY CIR.
38. CEDAR PL.
39. PLUM TREE CIR.
40. MAPLE CIR.
41. HEMLOCK CIR.
42. LILAC CIR.
43. HAZELWOOD CT.
44. HAZELWOOD CIR.
45. WAGON WHEEL CIR.
46. VENDELL ST.
47. ROBERTS CT.
48. ARCADIAN PL.
49. RASPBERRY CT.
50. RIDGE STONE PL.
51. W. FIR ST.
52. W. ELM ST.
53. W. DOUGLAS ST.
54. W. CEDAR ST.
55. W. BIRCH ST.
56. W. ASH ST.
57. CAMERON CIR.

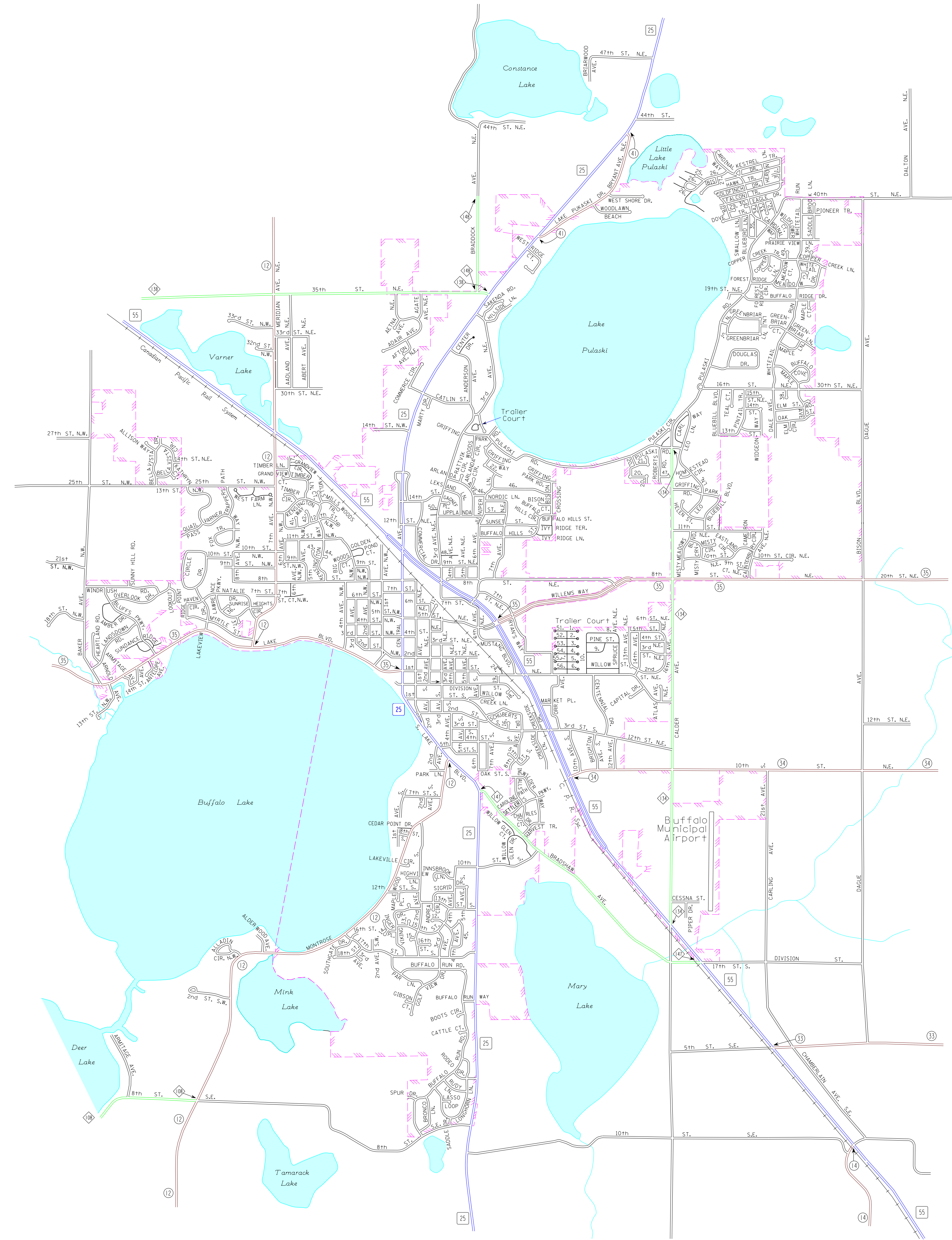

To request information from this document in an alternative format, call 651-366-4718 or 1-800-627-3774 (Greater Minnesota); 711 or 1-800-627-3529 (Minnesota Relay). You may also send an e-mail to ADRequest@state.mn.us. (Please request at least one week in advance).