

# MUNICIPALITY OF OWATONNA

PREPARED BY THE  
MINNESOTA DEPARTMENT OF TRANSPORTATION  
OFFICE OF TRANSPORTATION SYSTEM MANAGEMENT  
IN COOPERATION WITH  
U.S. DEPARTMENT OF TRANSPORTATION  
FEDERAL HIGHWAY ADMINISTRATION

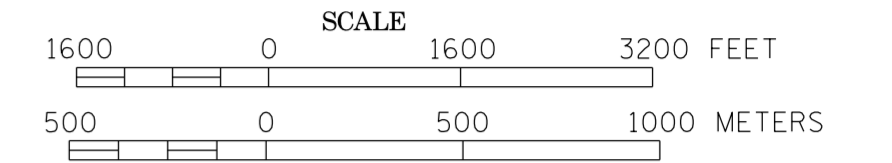

2015  
BASIC DATA - 2014

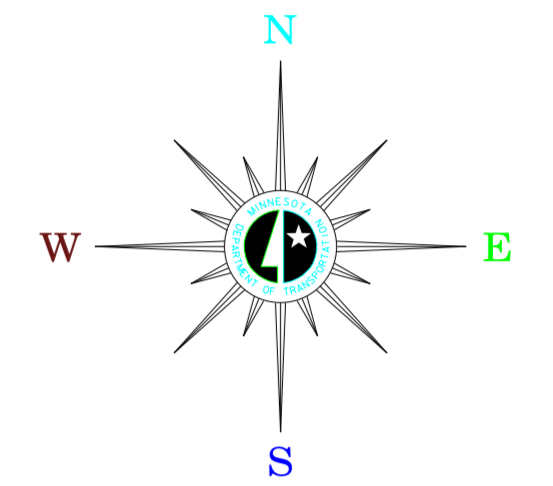

## LEGEND

- INTERSTATE TRUNK HIGHWAY..... 35
- U.S. TRUNK HIGHWAY..... 10
- STATE TRUNK HIGHWAY..... 55
- COUNTY STATE AID HIGHWAY..... 23
- COUNTY ROAD..... 15
- CORPORATE LIMITS.....
- PUBLIC ROAD.....
- PRIVATE ROAD.....

1. PLEASANT AVE.
2. INTERLADEN
3. ROLLING GREEN DR.
4. MAPLELEAF LN.
5. MAPLELEAF LN. N.E.
6. WATER TOWER PL. N.E.
7. GREENLEAF PL. S.E.
8. CHURCHILL DR.
9. BIRCHWOOD LN. S.E.
10. LITHAVEN LN. N.E.
11. LITHAVEN PL. N.E.
12. RASPBERRY RIDGE PL. N.E.

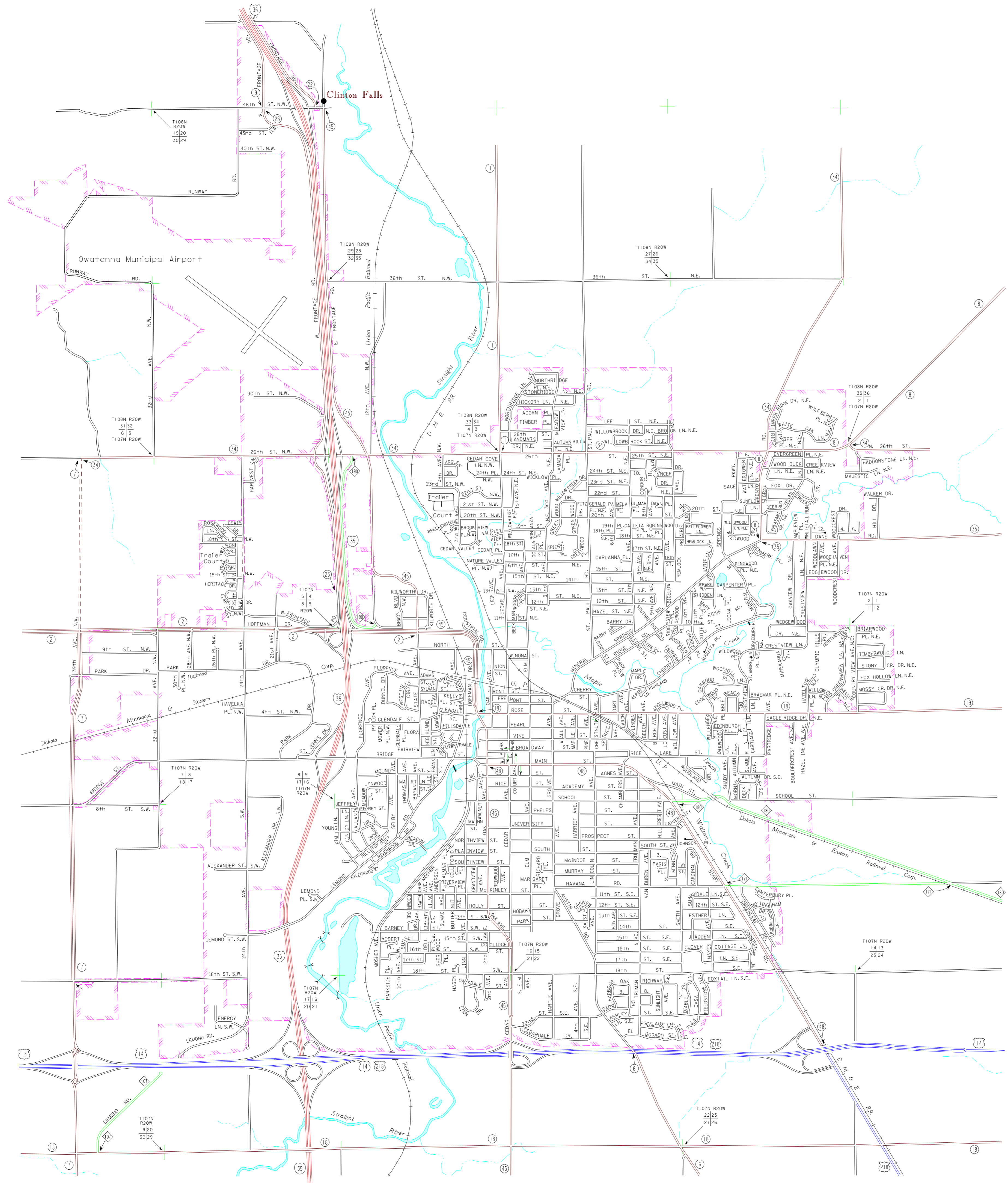

To request information from this document in an alternative format, call 651-368-4718 or 1-800-657-3774 (Greater Minnesota); 711 or 1-800-627-3529 (Minnesota Relay). You may also send an e-mail to ADRequest.dca@state.mn.us. (Please request at least one week in advance).