

36

31

# MUNICIPALITY OF DUNDEE

PREPARED BY THE  
MINNESOTA DEPARTMENT OF TRANSPORTATION  
OFFICE OF TRANSPORTATION SYSTEM MANAGEMENT

IN COOPERATION WITH  
U.S. DEPARTMENT OF TRANSPORTATION  
FEDERAL HIGHWAY ADMINISTRATION

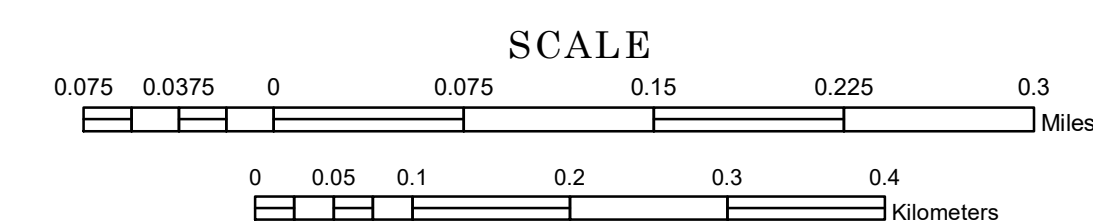

1 in = 400 ft

2023

Projection:  
Transverse Mercator  
NAD 1986  
UTM Zone 15

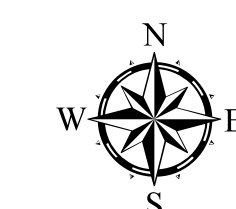

North American Datum  
of 1986

BELFAST

SOUTHBROOK

2

1

GRAHAM LAKES

LA CROSSE

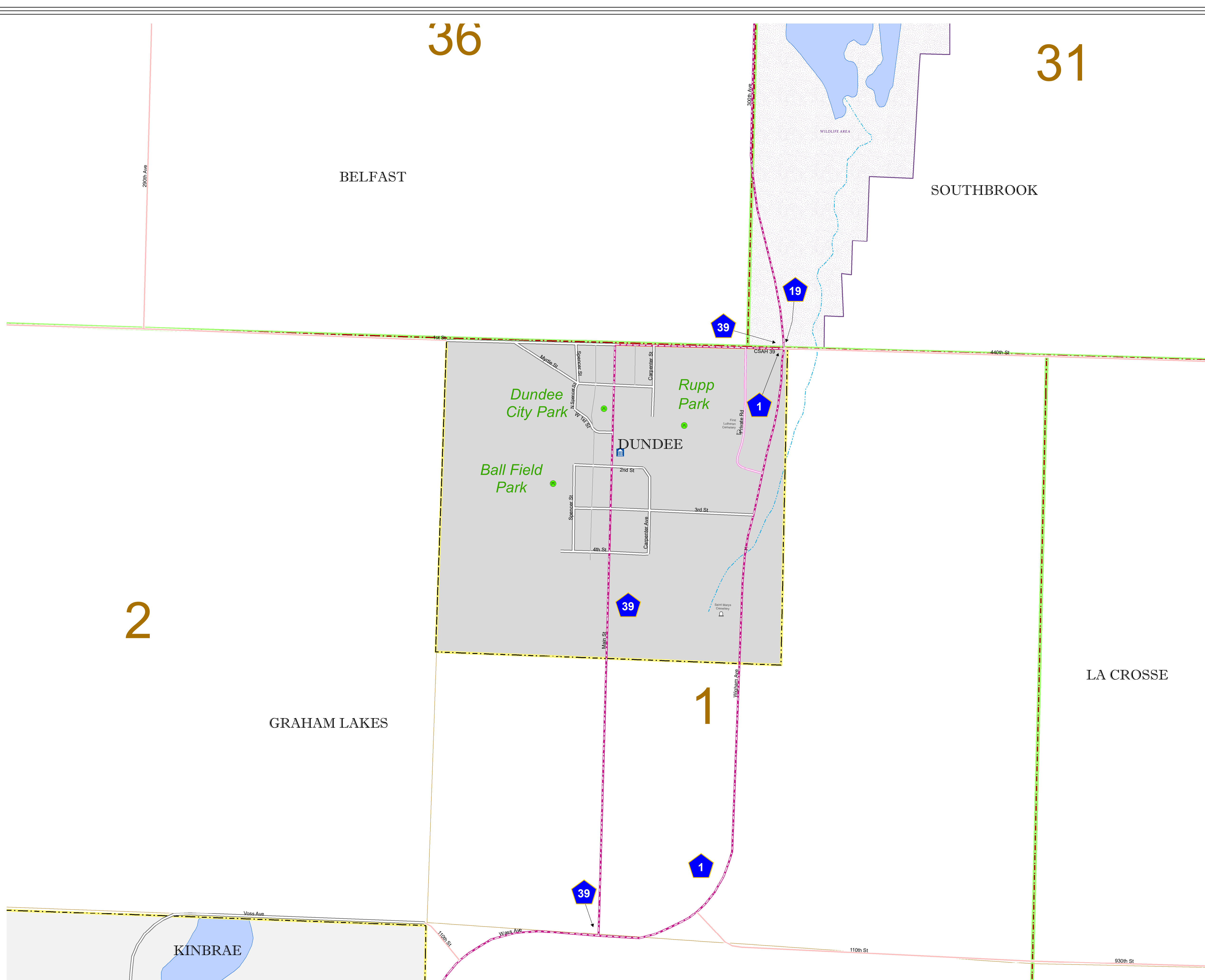

ROAD AND ROADWAY FEATURES	PUBLIC SERVICE FEATURES
INTERSTATE	MINOT OFFICE
US HIGHWAY	MINOT TRUCK STATION
BN HIGHWAY	HIGHWAY PATROL DISTRICT OFFICE
COUNTY STATE AID HIGHWAY	STATE TRAVEL INFORMATION CENTER
COUNTY ROAD	REST AREA (Full Service)
MUNICIPAL STREET	REST AREA (Quick Service)
MUNICIPAL STATE AID STREET	WAYSIDE (Only or Pre-Trip)
PRIVATE STREET/ROAD	PUBLIC ACCESS POINT
TOWNSHIP ROAD	LOCAL PARK
UNORGANIZED TERRITORY ROAD	FARBOUNDS
RAIMP OR CONNECTOR	PORT OF ENTRY
INTERSTATE EXIT	PARK AND RIDE LOT
GREAT RIVER ROAD	PUBLIC UNIVERSITY/COLLEGE
OTHER ROADS	PRIVATE UNIVERSITY/COLLEGE
Farm Road	ELEMENTARY SCHOOL
State Park	MIDDLE SCHOOL
National Park	HIGH SCHOOL
Monument	
State Forest	
National Forest	
National Wildlife	
State Game	
RAILROAD AND RAILWAY FEATURES	AVIATION FEATURES
RAILROAD	COMMERCIAL AIRPORT
EMPIRE BUILDER STATION (Amtrak)	GENERAL AIRPORT
NORTHSTAR STATION (Commuter)	AIRSTRIP
LIGHT RAIL	SEAPLANE
BLUE LINE STATION	AIRPORT RUNWAY
GREEN LINE STATION	
INFRASTRUCTURE FEATURES	CULTURAL FEATURES
LONG BRIDGE (100' or Greater Span)	STATE HISTORICAL MARKER
MEDIUM BRIDGE (20' to 100' Span)	HISTORIC DISTRICT
MINOR BRIDGE (0' to 20' Span)	HISTORIC SITE
ROAD TUNNEL (100' or Greater Span)	MONUMENT
RAILROAD TUNNEL (100' or Greater Span)	CEMETERY
RAILROAD BRIDGE (Lesser than 100' Span)	
SKYWAY	
PEDESTRIAN BRIDGE	
PEDESTRIAN TUNNEL	
DAM	
LOCK AND DAM	
PUBLIC FACILITIES	BOUNDARY FEATURES
STATE CAPITOL	MUNICIPALITY
FEDERAL COURTHOUSE	COUNTY
COUNTY COURTHOUSE	ADJACENT MUNICIPALITY
ARMORY	FEDERAL ADJUSTED URBAN AREA (2014)
CITY HALL	MILITARY
TOWN HALL	STATE PARK
COMMUNITY CENTER	REGIONAL PARK
ARENA	NATIONAL FOREST
STADIUM	NATIONAL AND STATE FOREST
POST OFFICE	STATE FOREST
POLICE STATION	NATIONAL TRAIL
FIRE STATION	WILDLIFE REFUGE AREA
PUBLIC LIBRARY	WILDLIFE MANAGEMENT AREA
PUBLIC MUSEUM	HYDROLOGIC FEATURES
EVENT CENTER	RIVER OR STREAM (PERMANENT)
	LAKE, POND OR RESERVOIR
	STREAM (PERMANENT)
	DRAINAGE DITCH
	WETLAND
	ISLAND OR LAND
	REGIONAL WATERSHED
CITY CENTERS	
TRIBAL GOVERNMENT CENTER	
CITY CENTER	
LOCALLY INCORPORATED PLACE	
UNINCORPORATED COMMUNITY	

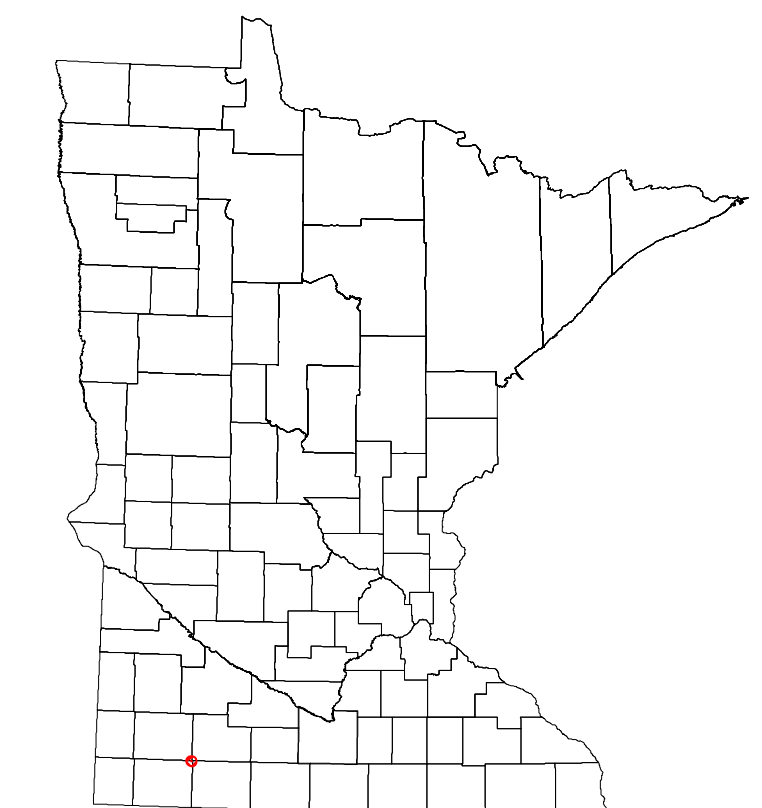

To request information from this document in an alternative format, call 651-366-4718 or 1-800-657-3774 (Greater Minnesota); 711 or 1-800-627-3529 (Minnesota Relay). You may also send an e-mail to ADarequest.dot@state.mn.us. (Please request at least one week in advance.)

LAST EDITED ON 12-10-2023

Population (U.S. Census 2020): 73