

MUNICIPALITY OF LONSDALE

PREPARED BY THE
MINNESOTA DEPARTMENT OF TRANSPORTATION
OFFICE OF TRANSPORTATION SYSTEM MANAGEMENT

IN COOPERATION WITH
U.S. DEPARTMENT OF TRANSPORTATION
FEDERAL HIGHWAY ADMINISTRATION



1 in = 800 ft

2023

Projection:
Transverse Mercator
NAD 1986
UTM Zone 15



North American Datum
of 1986

ROAD AND ROADWAY FEATURES	PUBLIC SERVICE FEATURES
INTERSTATE	MINDOT OFFICE
US HIGHWAY	MINDOT TRUCK STATION
STATE AID HIGHWAY	HIGHWAY PATROL DISTRICT OFFICE
COUNTY ROAD	STATE TRAVEL INFORMATION CENTER
MUNICIPAL STREET	REST AREA (Full Service)
MUNICIPAL STATE AID STREET	REST AREA (Only Truck)
PRIVATE STREET/ROAD	WAYSIDE (Only on Pk Trk 4+)
TOWNSHIP ROAD	PUBLIC ACCESS POINT
UNORGANIZED TERRITORY ROAD	LOCAL PARK
RAMP OR CONNECTOR	FARMS/BOUNDS
GREAT RIVER ROAD	PORT OF ENTRY
OTHER ROADS	PARK AND RIDE LOT
RAILROAD AND RAILWAY FEATURES	PUBLIC UNIVERSITY COLLEGE
EMPIRE BUILDER STATION (ARTHRX)	PRIVATE UNIVERSITY COLLEGE
NORTHSTAR STATION (COMASTER)	ELEMENTARY SCHOOL
LIGHT RAIL	MIDDLE SCHOOL
BLUE LINE STATION	HIGH SCHOOL
GREEN LINE STATION	AVIATION FEATURES
INFRASTRUCTURE FEATURES	COMMERCIAL AIRPORT
LONG BRIDGE (100' OR GREATER SPAN)	GENERAL AIRPORT
MAJOR BRIDGE (20' TO 100' SPAN)	AIRSTRIP
MINOR BRIDGE (0' TO 20' SPAN)	SEAPLANE
ROAD TUNNEL (100' OR GREATER SPAN)	AIRPORT RUNWAY
RAILROAD BRIDGE (100' OR GREATER SPAN)	CULTURAL FEATURES
RAILROAD BRIDGE (Lesser 100' SPAN)	STATE HISTORIC MARKER
SKYWAY	HISTORIC DISTRICT
PEDESTRIAN BRIDGE	HISTORIC SITE
PEDESTRIAN TUNNEL	MONUMENT
DAM	CEMETERY
LOCK AND DAM	BOUNDARY FEATURES
PUBLIC FACILITIES	TRIBAL LAND
STATE CAPITOL	COUNTY
FEDERAL COURTHOUSE	MUNICIPALITY
COUNTY COURTHOUSE	ADJACENT MUNICIPALITY
ARMORY	FEDERAL ADJUSTED URBAN AREA (2014)
CITY HALL	MILITARY
COMMUNITY CENTER	STATE PARK
ARENA	REGIONAL PARK
STADIUM	NATIONAL FOREST
POST OFFICE	NATIONAL AND STATE FOREST
POLICE STATION	STATE FOREST
FIRE STATION	NATIONAL TRAIL
PUBLIC LIBRARY	WILDLIFE REFUGE AREA
PUBLIC MUSEUM	WILDLIFE MANAGEMENT AREA
EVENT CENTER	HYDROLOGIC FEATURES
CITY CENTERS	RIVER OR STREAM (PERMANENT)
TRIBAL GOVERNMENT CENTER	LAKE, POND OR RESERVOIR
CITY CENTER	STREAM (Intermittent)
LOCALLY INCORPORATED PLACE	DRAINAGE DITCH
UNINCORPORATED COMMUNITY	WETLAND
	ISLAND OR LAND
	REGIONAL WATERSHED

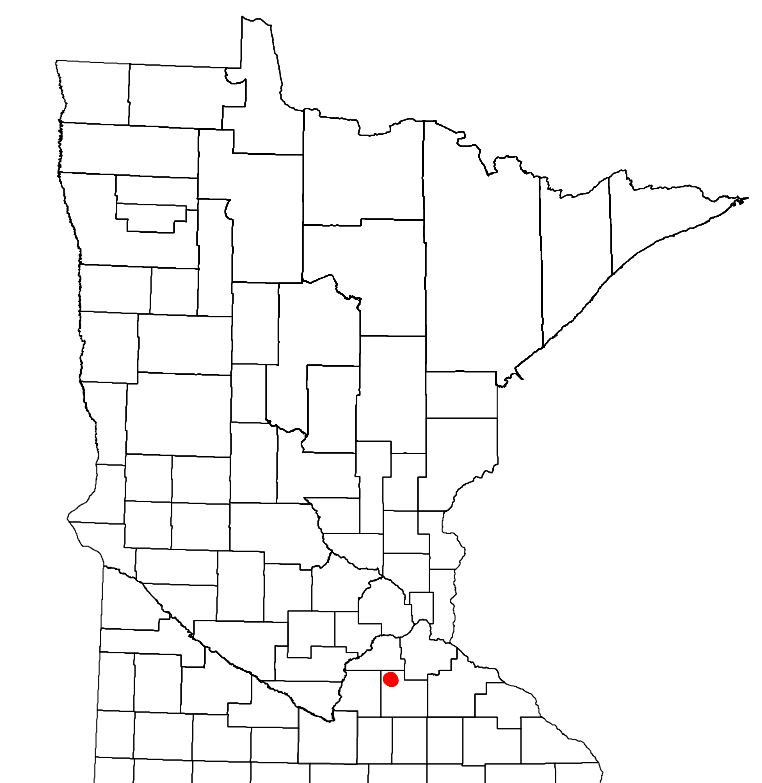

Population (U.S. Census 2020): 4686

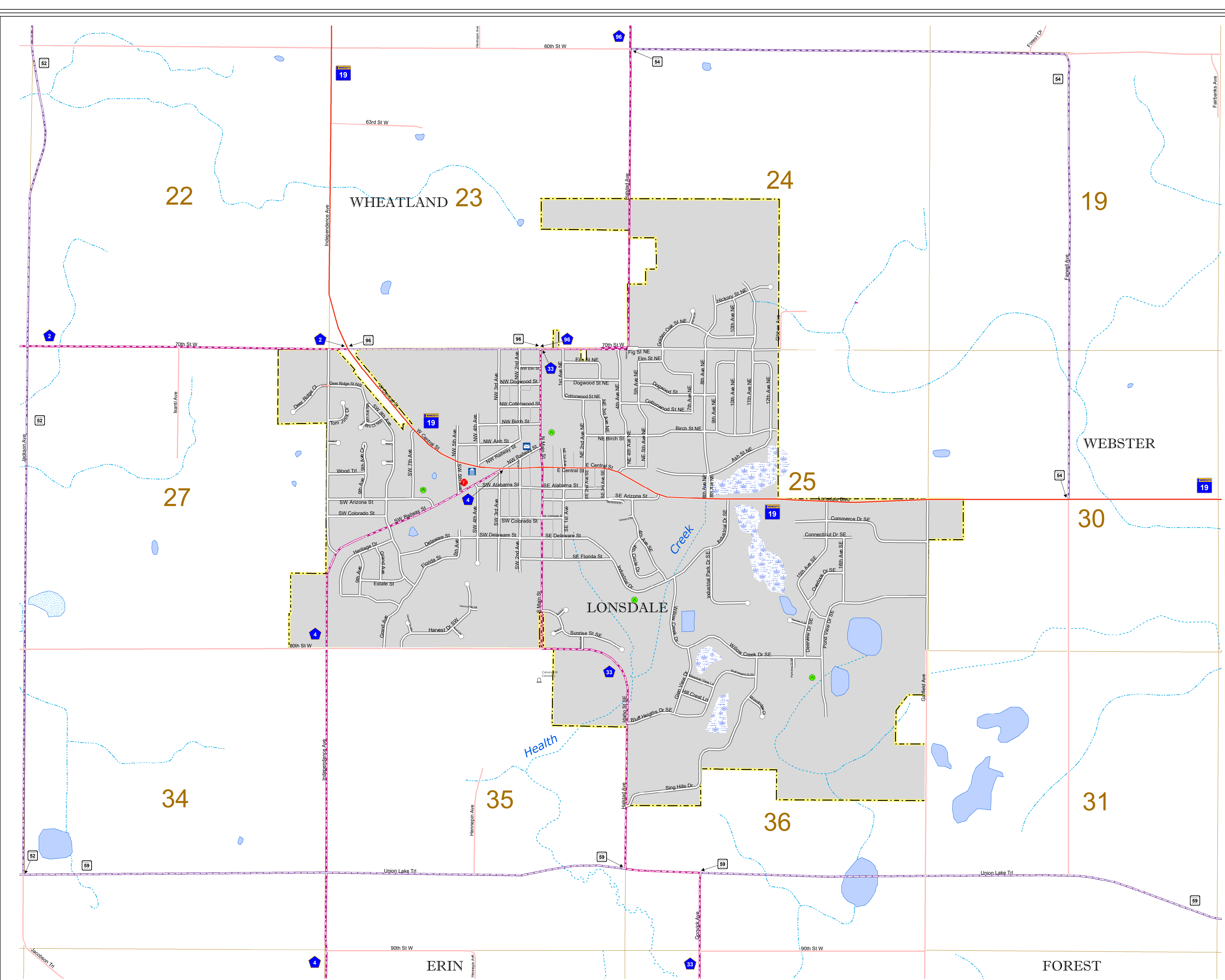

To request information from this document in an alternative format, call 651-366-4718 or 1-800-657-3774 (Greater Minnesota); 711 or 1-800-627-3529 (Minnesota Relay). You may also send an e-mail to ADRequest.dot@state.mn.us. (Please request at least one week in advance.)

LAST EDITED ON 12-10-2023