

MUNICIPALITY OF ALBANY

PREPARED BY THE
MINNESOTA DEPARTMENT OF TRANSPORTATION
OFFICE OF TRANSPORTATION SYSTEM MANAGEMENT

IN COOPERATION WITH
U.S. DEPARTMENT OF TRANSPORTATION
FEDERAL HIGHWAY ADMINISTRATION

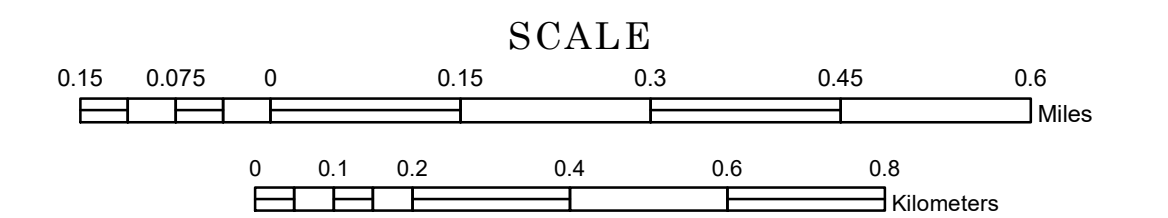

1 in = 800 ft

2023

Projection:
Transverse Mercator
NAD 1986
UTM Zone 15

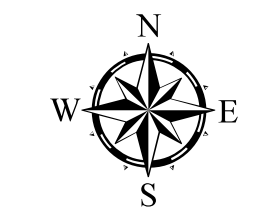

North American Datum
of 1986

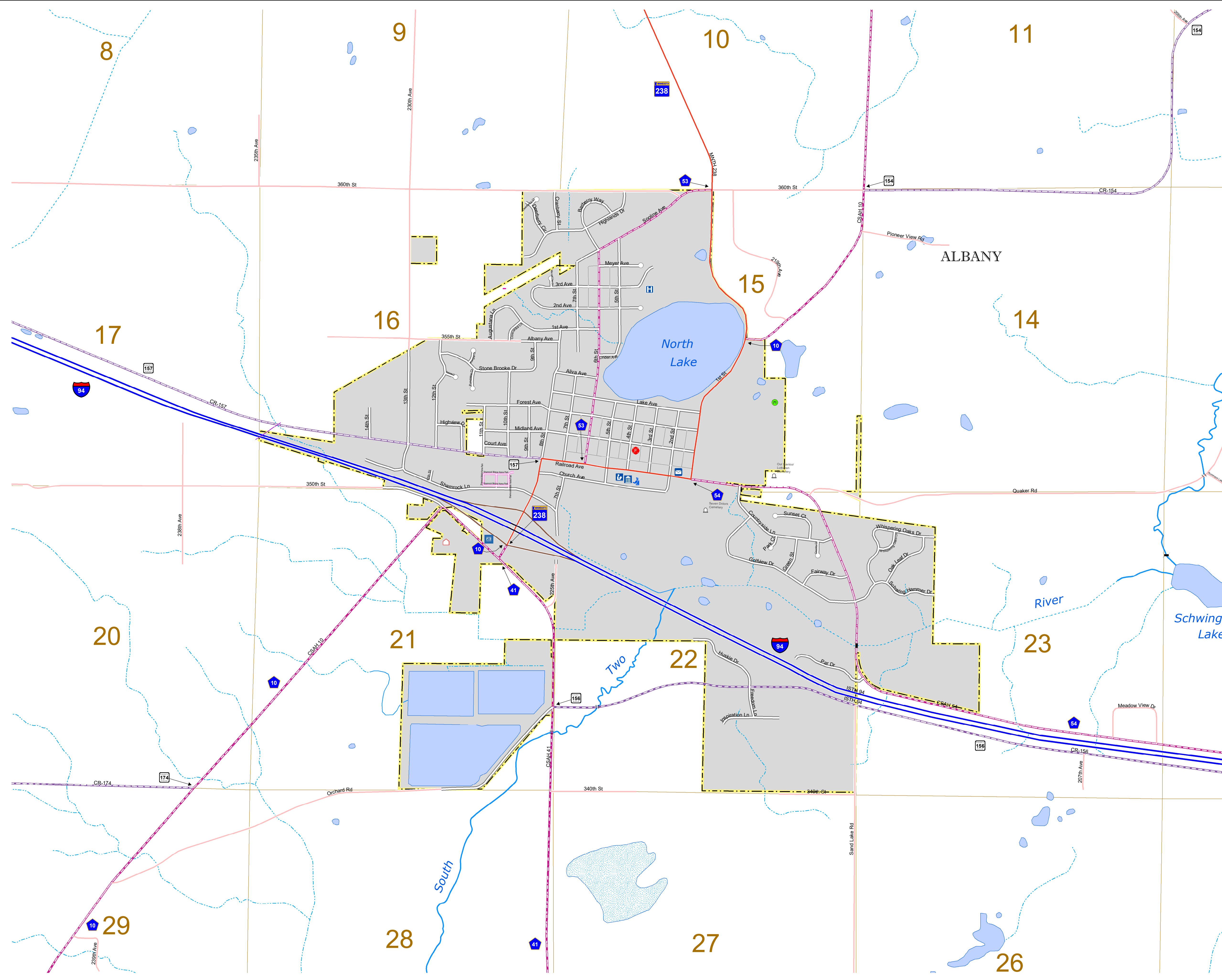

ROAD AND ROADWAY FEATURES	PUBLIC SERVICE FEATURES
INTERSTATE	MINDOT OFFICE
US HIGHWAY	MINDOT TRUCK STATION
STATE HIGHWAY	HIGHWAY PATROL DISTRICT OFFICE
COUNTY STATE AID HIGHWAY	STATE TRAVEL INFORMATION CENTER
COUNTY ROAD	REST AREA (Full Service)
MUNICIPAL STREET	REST AREA (Only Truck)
MUNICIPAL STATE AID STREET	WAYSIDE (Only on Pk/Tor+V)
PRIVATE STREET/ROAD	PUBLIC ACCESS POINT
TOWNSHIP ROAD	LOCAL PARK
UNORGANIZED TERRITORY ROAD	FARBOUNDS
RAMP OR CONNECTOR	PORT OF ENTRY
INTERSTATE EXIT	PARK AND RIDE LOT
GREAT RIVER ROAD	PUBLIC UNIVERSITY COLLEGE
OTHER ROAD	PRIVATE UNIVERSITY COLLEGE
FARMROAD	ELEMENTARY SCHOOL
INDUSTRIAL PARK	MIDDLE SCHOOL
NATIONAL FOREST	HIGH SCHOOL
MILITARY	AVIATION FEATURES
RAILROAD AND RAILWAY FEATURES	COMMERCIAL AIRPORT
EMPIRE BUILDER STATION (AIRTRAK)	GENERAL AIRPORT
NORTHSTAR STATION (COMMUTERS)	AIRSTRIP
LIGHT RAIL	SEAPLANE
BLUE LINE STATION	AIRPORT RUNWAY
GREEN LINE STATION	CULTURAL FEATURES
INFRASTRUCTURE FEATURES	STATE HISTORICAL MARKER
LONG BRIDGE (100' OR GREATER SPAN)	HISTORIC DISTRICT
MAJOR BRIDGE (20' TO 100' SPAN)	HISTORIC SITE
MINOR BRIDGE (0' TO 20' SPAN)	MONUMENT
ROAD TUNNEL (100' OR GREATER SPAN)	CEMETERY
RAILROAD BRIDGE (100' OR GREATER SPAN)	TRIBAL LAND
RAILROAD BRIDGE (LESSER THAN 100' SPAN)	COUNTY
SKYWAY	MUNICIPALITY
PEDESTRIAN BRIDGE	ADJACENT MUNICIPALITY
PEDESTRIAN TUNNEL	FEDERAL ADJUSTED URBAN AREA (2014)
DAM	PUBLIC FACILITIES
LOCK AND DAM	STATE CAPITOL
STATE CAPITOL	FEDERAL COURTHOUSE
FEDERAL COURTHOUSE	COUNTY COURTHOUSE
COUNTY COURTHOUSE	ARMORY
ARMORY	CITY HALL
CITY HALL	COMMUNITY CENTER
COMMUNITY CENTER	ARENA
ARENA	STADIUM
STADIUM	POST OFFICE
POST OFFICE	POLICE STATION
POLICE STATION	FIRE STATION
FIRE STATION	PUBLIC LIBRARY
PUBLIC LIBRARY	PUBLIC MUSEUM
PUBLIC MUSEUM	EVENT CENTER
EVENT CENTER	CITY CENTERS
CITY CENTERS	TRIBAL GOVERNMENT CENTER
TRIBAL GOVERNMENT CENTER	CITY CENTER
CITY CENTER	LOCALLY INCORPORATED PLACE
LOCALLY INCORPORATED PLACE	UNINCORPORATED COMMUNITY
UNINCORPORATED COMMUNITY	REGIONAL WATERSHED
REGIONAL WATERSHED	

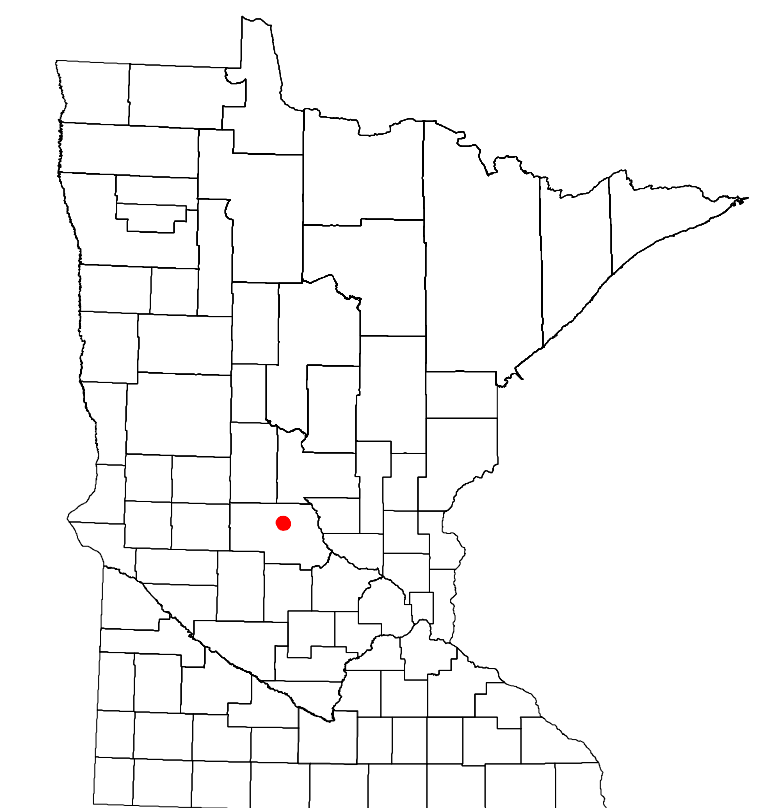

To request information from this document in an alternative format, call 651-366-4718 or 1-800-657-3774 (Greater Minnesota); 711 or 1-800-627-3529 (Minnesota Relay). You may also send an e-mail to ADRequest.dot@state.mn.us. (Please request at least one week in advance.)

LAST EDITED ON 12-10-2023

Population (U.S. Census 2020): 2780